

T6 RHTP

RELATIVE HUMIDITY, TEMPERATURE AND PRESSURE

IoT tracking device

T6 is an IoT device for long-term tracking and data monitoring of assets and equipment globally.

Featuring robust casing with long battery life, it comes with advanced and intelligent sensor technology.

This RHTP edition features high precision humidity, temperature and air pressure monitoring.



LTE



Battery



IP65 casing



Position



Utilization



Motion



Shock



Tilt



Light



Humidity



Temperature



Air pressure



T6 is a small IoT tracking device and data logger that offers **asset monitoring and data tracking** of any asset; from non-powered equipment to entire fleets.

Its **robust casing** is suited for all industrial environments and all-weather conditions with an operating temperature range from -30°C to $+85^{\circ}\text{C}$. Battery life-time is typically 7 years based on 1 transmission/day.

The device uses the newest global LTE network technology, to send transmissions to a server. Transmissions can be set at user-fixed intervals and if specified events occur.

A built-in **3-axis accelerometer** offers high-precision data on motion, shock and orientation, while other sensors track light and temperature.

Position data is acquired by **GPS** or via mobile network triangulation if GPS is not available.

This **RHTP** edition features high precision **humidity, temperature and air pressure** monitoring in one device.

This makes it especially suited for use in logistics and supply chain tracking or in connection with any monitoring of **sensitive equipment** to ensure compliance or healthy working conditions.

Data can be viewed on a cloud-based data portal that provides **complete visibility and data analytics**. It provides insights on location, performance, and status of assets and equipment. Data is available on maps, in graphs and in reports. API options are available.

Devices out of GSM coverage will **log data input** until coverage is available again.

Flight mode feature is available to suppress all radio transmissions to ensure safe conditions during flight.

Specifications

	Type: T6.420
Battery lifetime	Typical 7000 transmissions based on 1 transmission/day *
Sensors	Humidity, Temperature, Air pressure, Position, Motion, Tilt, Light, Utilization, 3-axis Shock (up to 8 g)
Data log	Store-and-forward log, default 300 entries of all data incl. position and sensor data
Antenna, GPS	Internal
Antenna, LTE/2G	Internal
Network technology	LTE Cat M1 / GSM EGPRS (850/900/1800/1900MHz)
SIM	Embedded, subscription required
Server communication	LTE/2G
Server protocols	API available upon request
Configuration	Via server
External tag connectivity	No
Housing	PA6 (nylon) potted with epoxy
IP rating	IP65
Maximum allowed continuous acceleration	8 g
Dimensions	68 x 68 x 45 mm
Weight	280 g
Battery package	47 Wh (Primary lithium, encapsulated)
Lithium content	3,8 gram
Temperature, operating	-30 °C to +85 °C
Temperature, storage	+30 °C max (recommended)
ADR	UN3091
US content	0%
ECCN	EAR99
HS (TARIC export) code	8526912020
Country of origin	Made in Denmark

Typical number of transmissions

Network	LTE	LTE/2G **	2G
1 transmission/day	7000	6000	5000
4 transmissions/day	10000	8000	7000
24 transmissions/day	11000	9000	8000

Without GPS, add 10% to above

*) Depending on signal and temperature conditions

**) 50% LTE and 50% 2G

RHTP specifications

Operating range	-30 to +85 °C 0 to 100% rel. humidity 300 to 1100 hPa
Temperature accuracy	+/-0,5 °C @ 25 °C
Temperature accuracy	+/-1,5 °C @ full scale
Humidity sensor accuracy	+/-3% rel. humidity
Humidity sensor hysteresis	+/-1% rel. humidity
Air pressure accuracy	±1,7 @ -20 ... 0 °C
Air pressure accuracy	±1,0 @ 0 ... 65 °C

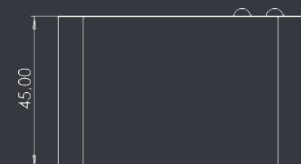
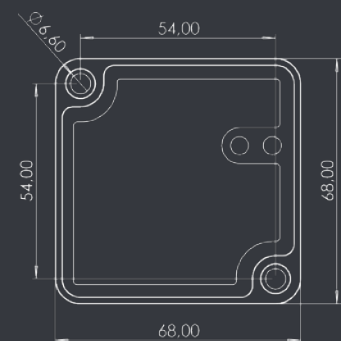
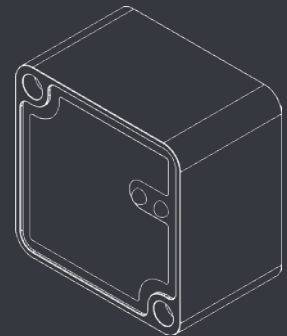

Version 10 - Subject to change without notice.
This data sheet references to firmware 3.54 or newer.