

## Tinytag Splash 2 (-30 to +105°C)

### TG-4105

#### Issue 5

17th October 2014  
E&OE

Waterproof, with a temperature rating of 105°C, this unit is suitable for use in a number of applications such as industrial dishwashers.

The unit has a high visibility yellow case and an external probe which gives it a fast response time.

The unit can be returned to base for repair, calibration and battery replacement.

Data is downloaded to the computer via a USB or serial download pad. This 'wireless connection' eliminates the need for sockets with waterproof caps which can easily be lost or forgotten.

#### Popular Applications

- Dish Washers
- Food processing
- Pasteurisation



#### Features

- Submersible temperature recorder
- Waterproof to 15m
- 32,000 reading capacity
- User-programmable logging interval
- 2 user-programmable alarms
- Delayed and trigger start options
- 3 stop options
- Low battery warning

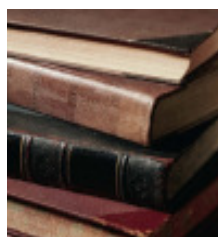

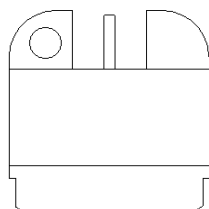

### Features

<b>Total Reading Capacity</b>	32,000 readings
<b>Memory type</b>	Non Volatile
<b>Trigger Start</b>	Magnetic Switch
<b>Delayed Start</b>	Relative / Absolute (up to 45 days)
<b>Stop Options</b>	When full After n Readings Never (overwrite oldest data)
<b>Reading Types</b>	Actual, Min, Max
<b>Logging Interval</b>	1 sec to 10 days
<b>Offload</b>	While stopped or when logging in minutes mode
<b>Alarms</b>	2 fully programmable; latchable

### Reading Specification

<b>Reading Range</b>	-30 °C to +105 °C (-22 °F to +221 °F)
<b>Sensor Type</b>	PT1000 (Integral Probe)
<b>Response Time</b>	10 seconds to 90% FSD in water
<b>Reading Resolution</b>	0.01 °C or better

### Reading Accuracy

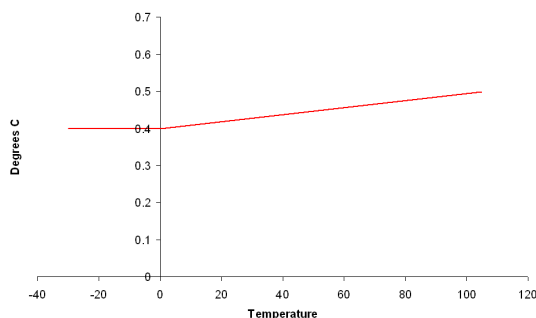

### Physical Specification

<b>IP Rating</b>	IP68 (waterproof) to 15m
<b>Operational Range*</b>	-30 °C to +105 °C (-22 °F to +221 °F)
<b>Case Dimensions</b>	
<b>Diameter</b>	51mm / 2.01"
<b>Height</b>	51mm / 2.01"
<b>Weight</b>	95g / 3.35oz

\*The Operational Range indicates the physical limits to which the unit can be exposed, these limits should not be exceeded.

### Calibration

This unit is configured to meet Gemini's quoted specification during its manufacture.

We recommend that the calibration of this unit should be checked annually against a calibrated reference meter.

A certificate of calibration, traceable to a national standard, can be supplied for an additional charge either at the point of purchase, or if the unit is returned for a service calibration.

### Notes

**This logger contains no user-serviceable parts and should not be opened.**

**Battery Replacement Interval** Annually\*

\*If deployed for long periods, the logger's battery should be replaced annually to prevent the loss of data during a recording run. If the logger is being used frequently, the battery should be changed when prompted by a low battery warning from the Tinytag Explorer software.

The battery in this unit can only be replaced by Gemini Data Loggers (UK) Ltd. or an authorised representative. Please see [www.tinytag.info/support](http://www.tinytag.info/support) for further information.

The position of the unit's trigger start switch is indicated by the . . . marking on its base. The switch itself is positioned on the side of the unit, just above the base-lid join, on the edge indicated. When a magnet is held in the correct location, the status LED will light until the magnet is removed.

### LED Flash Patterns

When logging, a status LED is visible through the base of the unit. The flash patterns of this indicator are as follows:

Status LED Flash Pattern	Indication
1 flash every 4 seconds	Logging
1 flash every 8 seconds	Waiting to Log (trigger or delayed start set)
A double flash every 4 seconds	Alarm limit breached

### Approvals

Gemini Data Loggers (UK) Ltd. operates a Business Management System which conforms to ISO 9001 and ISO 14001.



### Required and Related Products

To use this data logger you will require a copy of the following software:

SWCD-0040: Tinytag Explorer software

and an ACS-3030: USB Inductive Pad

### Further Related Products

SER-9525: Tinytag Aquatic 2 Service Kit